

Order No. R800 8030



Relay Xo is a 1-in, 2-out switcher designed to route the output of a microphone to two different audio inputs. This, for instance, enables a vocalist to switch his mic between the main PA system and the monitors so that he can discreetly communicate with other band members or the technical staff. Another use involves sending the output to two channels on the PA whereby one channel is set 'dry' to speak to the audience between sets, while the other channel is set 'wet' with reverb and echo to enhance the voice. The remote switch capability allows the vocalist to control the effects. The Relay Xo features balanced XLR inputs and outputs. Because the audio signal path is completely passive, it may be used with mic and line level signals. Switching can be done using the on-board switch or remotely controlled using the Radial JR1 heavy-duty footswitch or any latching/momentary switch. Choice of XLR and ¼" remote input jacks. An additional ¼" remote link jack enables multiple Relay Xos to be used in tandem.

Features

- Balanced input with A and B outputs
- 100% passive with sealed relay switching
- On-board and remote switching
- Units may be linked for stereo switching

Applications

- Press-to-talk on-stage communication system
- Switch a mic between two mixer channels
- Select between two effect processors
- Toggle a signal between two audio destinations

Cool stuff

- Helps deliver a more professional show
- Works with any balanced audio signal
- Choice of latching or momentary remote footswitch
- Built 'Radial Rugged' for pro use



- JR1 REMOTE: Locking XLR and ¼" combo jack used to connect a remote switch. Use with footswitches and MIDI contact closure outputs.
- REMOTE LINK: Allows stereo and multi-channel switching by linking additional Relay Xo units together with ¼" patch cables.
- MIC/LINE INPUT: Balanced XLR input. Signal path is 100% passive and works with any audio signal.
- STEEL I-BEAM ENCLOSURE: Inner I-beam profile eliminates stress that could torque the PC board.



- OUTPUT-B: Alternate balanced XLR output. The B-LED illuminates when the output is active or when a remote switch is closed.
- OUTPUT-A: Main balanced XLR output. The A-LED illuminates when the output is active or when a remote switch is open.
- CABLE CLAMP: Prevents accidental power disconnection by locking down the AC adapter cable.
- POWER: Input for the included 15 volt (400mA) AC power adapter.
- NO SLIP PAD: Provides electrical and mechanical isolation and keeps the Relay Xo from sliding around.

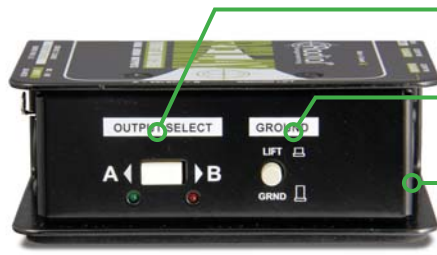

- OUTPUT SELECT: This switch toggles the Relay Xo between outputs A and B. An LED indicator displays the active output.
- GROUND LIFT: Disconnects pin-1 (ground) on the input XLR jack to help reduce hum and buzz caused by ground loops.
- 14 GAUGE STEEL: Outer shell features bookend design that creates a protective zone around connectors and switches.



JR1-L: Latching remote footswitch.



JR1-M: Momentary remote footswitch.

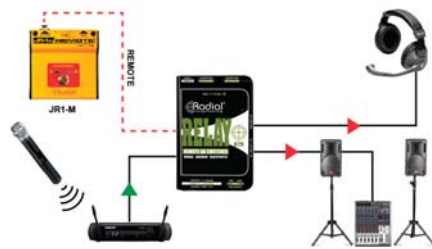

Switch mic between live and Intercom
Use the Relay Xo to switch the vocal mic between the PA system and intercom so that you can speak to the technical crew or other band members. Use the optional JR1-M momentary footswitch to remotely control. This avoids unsightly hand signals!

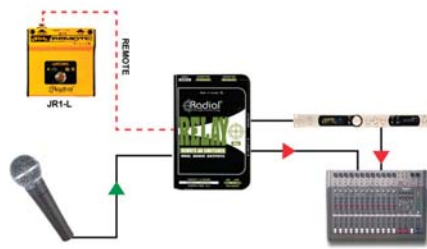

Switch from dry to wet audio channels
On gigs where you do not have your regular soundman, use the Relay Xo to toggle between a dry channel on the mixer to chat with the crowd - and a wet channel with reverb and delay to enhance your vocals when singing. Use the optional Radial JR1-L latching footswitch for switching.

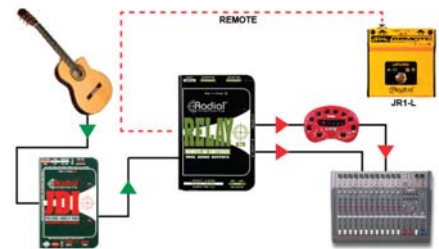

Add special effects to your acoustic guitar
Ever wish you could add special effects to your acoustic guitar for solos or a particular song? Use the Relay to toggle between normal and solo channels on the mixer. Use the Radial JR1-L to remotely control and toggle between the two like an Eric Clapton solo!