



Instruction Manual

AP-536
HDMI Audio Extractor

Table of Contents

1.0	Introduction	2
2.0	Specifications	3
3.0	Checking Package Contents	3
4.0	Connecting The Hardware	4
5.0	Operating The Unit	4
6.0	Troubleshooting	5
7.0	Limited Warranty	5
8.0	Regulatory Compliance	6
9.0	Contacts	6

1.0 INTRODUCTION

Thanks for purchasing this AP-536 HDMI Audio Extractor from the AV Toolbox division of TV One. The AP-536 is a compact device that allows you to extract embedded audio from an HDMI signal. Some video displays accept an HDMI video signal but do not provide a way to process the embedded audio. The AP-536 will extract, process and present for distribution virtually any of the standard embedded audio formats and provide both optical and analog outputs for connection to your audio amplification system. AV Toolbox offers a wide range of video, audio and multimedia products.

1.1 Liability Statement

Every effort has been made to ensure that this product is free of errors. AV Toolbox cannot be held liable for the use of this hardware or any direct or indirect consequential damages arising from its use. It is the responsibility of the user of the hardware to check that it is suitable for his/her requirements and that it is installed correctly. All rights reserved. No parts of this manual may be reproduced or transmitted by any form or means electronic or mechanical, including photocopying, recording or by any information storage or retrieval system without the written consent of the publisher.

AV Toolbox reserves the right to revise any of its hardware and software following its policy to modify and/or improve its products where necessary or desirable. This statement does not affect the legal rights of the user in any way.

All third party trademarks and copyrights are recognised. The AV Toolbox logo is a trademark of AV Toolbox. All other trademarks are the property of their respective holders.

1.2 Features

The AP-536 HDMI Audio Extractor has many features that enable it to perform in a superior manner. Among those features you will find:

- Compliant with HDMI 1.3, HDCP 1.2 and DVI 1.0
- HDMI Sample Rates to 192 kHz
- Audio spectrum Sample Rates to 48kHz
- 225 MHz Clock Rate
- Supports High Bit Rate Audio
- Selectable Audio EDID of TV, LPCM 2.0 or Bitstream
- 1080p HDMI Cable distance of 15 Meters (50 ft.)
- Simple installation
- Low Power Consumption

2.0 SPECIFICATIONS

Signal Input	
HDMI	1x Type A HDMI Connector
Signal Outputs	
HDMI	1x Type A HDMI Connector
Optical Audio	1x Optical Audio Connector
L/R Analog Audio	2x RCA (L/R) Connectors
Performance	
HDMI Audio Formats	LPCM 2.0/5.1/7.1, Dolby 5.1, DTS 5.1, DD+ Dolby TrueHD, DTS-HD Master Audio
Optical Audio Formats	LPCM 2.0, Dolby 5.1, DTS 5.1
L/R Audio Format	Stereo audio
HDMI Sample Rate	Up to 192 kHz
Optical Audio Sample Rate	48kHz
Audio Bandwidth	20 Hz to 20 KHz
Mechanical	
Size (H-W-D)	34x91x86mm (1.3"x3.6"x3.4")
Weight (Net)	90g (3.17 oz.)
Warranty	
Limited Warranty	1 Year Parts and Labor
Environmental	
Operating Temperature	0° to +40° C (+32° to +104° F)
Operating Humidity	10% to 90%, Non-condensing
Storage Temperature	0° to +40° C (+32° to +104° F)
Storage Humidity	10% to 90%, Non-condensing
Power Requirement	
External Power Supply	5VDC@1.2A
Regulatory Approvals	
Audio Extractor	FCC, CE, RoHS
Power Adapter	UL, CUL, CE, PSE, GS, RoHS
Accessories Included	
1x Power Adapter	US, UK or Euro
1x Operations Manual	
Product Item Number	AP-536 HDMI Audio Extractor

3.0 CHECKING PACKAGE CONTENTS

Before attempting to use this unit, please check the packaging and make certain the following items are contained in the shipping carton:

- 1x AP-536 HDMI Audio Extractor
- 1x AC Adapter
- 1x Operation Manual

Note: Please retain the original packing material should the need ever arise to return the unit. If you find any items are missing, contact your reseller or TV One immediately. Have the Model Number, Serial Number and Invoice available for reference when you call.

4.0 CONNECTING THE HARDWARE

Please study the panel drawings below and become familiar with the Signal Input, Outputs, Power connector and On/Off switch plus the Signal adjustment control location.

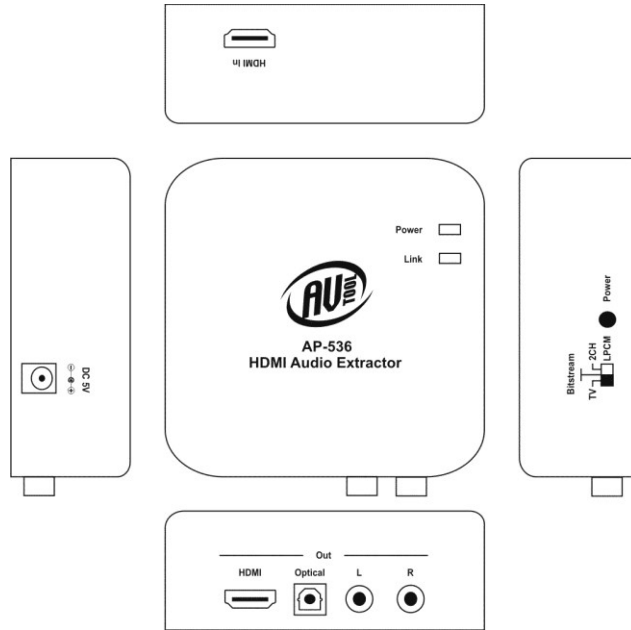

Connect the HDMI output from the source equipment to the HDMI In connector on the AP-536. Next, connect the AP-536's Optical or L and R outputs to the destination audio equipment. Optionally, connect the HDMI Out to an HDMI display device.

Set the audio EDID switch on the right side of the AP-536 to the desired audio support mode (TV Pass-through, Bitstream or 2 Channel LPCM).

Note: The Optical output supports Dolby Digital, DTS and LPCM 2.0 sources. The L/R Audio output can only support LPCM 2.0 audio sources.

Connect the AC adapter to the AP-536 and to a working AC power socket. You may then turn on the destination equipment and the source equipment.

5.0 OPERATING THE UNIT

Other than connecting power, connecting the cables to the source and destination equipment and making the desired audio support selection, there are no operator interventions required.

6.0 TROUBLESHOOTING

In the event that the unit appears to be non-functional, make certain that the AC power outlet is active for the source and destination equipment as well as the AP-536. Next, substitute each cable in use with a known good cable to remove that variable.

After trying the above suggestions should the problem still persist, contact your dealer for additional suggestions before contacting AV Toolbox. Should the dealer's technical personnel be unable to assist you, contact AV Toolbox via the TV One support website: <http://tvone.crmdesk.com>. Create a technical support request on the site and our support team will respond within a short period of time.

7.0 LIMITED WARRANTY

LIMITED WARRANTY – AV Toolbox warrants the original purchaser that the equipment it manufactures will be free from defects in materials and workmanship for a period of one year from the date of purchase. Should this product, in AV Toolbox's opinion, prove defective within this warranty period, AV Toolbox, at its option, will repair or replace this product without charge. Any defective parts replaced become the property of AV Toolbox. This warranty does not apply to those products which have been damaged due to accident, unauthorized alterations, improper repair, modifications, inadequate maintenance and care, or use in any manner for which the product was not originally intended.

If repairs are necessary under this warranty policy, the original purchaser must obtain a Return Authorization Number from AV Toolbox and return the product to a location designated by AV Toolbox, freight prepaid. After repairs are complete, the product will be returned, freight prepaid.

LIMITATIONS - All products sold are "as is" and the above Limited Warranty is in lieu of all other warranties for this product, expressed or implied, and is strictly limited to one year from the date of purchase. AV Toolbox assumes no liability to distributors, dealers or end-users for any loss of use, revenue or profit.

AV Toolbox makes no other representation of warranty as to fitness for the purpose or merchantability or otherwise in respect of any of the products sold. The liability of AV Toolbox with respect to any defective products will be limited to the repair or replacement of such products. In no event shall AV Toolbox be responsible or liable for any damage arising from the use of such defective products whether such damages be direct, indirect, consequential or otherwise, and whether such damages are incurred by the reseller, end-user or any third party.

8.0 REGULATORY COMPLIANCE

The AP-536 HDMI Audio Extractor has been tested for compliance with appropriate FCC and CE rules and regulations. The Power Adaptor/Supplies have been tested for compliance with appropriate UL, CUL, CE, PSE, GS Rules, Regulations and/or Guidelines. These Products and Power Adapters are RoHS Compliant.

9.0 CONTACT INFORMATION

Should you have questions or require assistance with this product in areas not covered by this manual, please contact AV Toolbox at the appropriate location.

AV Toolbox

A division of TVOne
2791 Circleport Drive
Erlanger, KY 41018
USA
Tel 859-647-1077
Fax 859-282-8225
sales@avtoolbox.com
www.avtoolbox.com

AV Toolbox

A division of TV One Ltd
Continental Approach
Westwood Industrial Estate
Margate, Kent CT9 4JG, UK
Tel +44 (0)1843 873307
Fax +44 (0)1843 873312
sales.europe@avtoolbox.com
www.avtoolbox.co.uk

AV Toolbox Latin America

A division of TV One L.A.
6991 NW 82 Avenue #8
Miami, FL 33166
USA
Tel 305-396-6275
Fax 305-418-9306
sales.latinoamerica@tvone.com
www.avtoolboxla.com

TV One Mercosur

Av. Diaz Velez 3965 #PB
(1200) Capital Federal
Buenos Aires, Argentina
Tel +54 11 5917-2525
Fax +54 11 4032-0281
sales.mercosur@tvone.com
www.tvonela.com

TV One Asia

16F-4, NO.75, Sec. 1
Xintai 5th Rd., Xizhi Dist.
New Taipei City 22101
Taiwan R.O.C.
Tel +886 2 2698-2296
Fax +886 2 2698-2297
sales.asia@tvone.com
www.tvoneasia.com

TV One China

Rm. 1007, Golden Peach Bldg.
No. 1900 Shangcheng Road
Pudong, Shanghai
China 200120
Tel +86 21 5830-2960
Fax +86 21 5851-7949
Email: sales.china@tvone.com
www.tvonechina.com

End of Manual